

**S** [www.slservice.pl](http://www.slservice.pl)  
**LIGHTING**



# **S-PROFILE**

**USER MANUAL**

# TABLE OF CONTENTS

1.	INTRODUCTION	3
2.	SAFETY INFORMATION	3
3.	PRODUCT INFORMATION	4
3.1	SPECIFICATION	4
3.2	CLEANING AND MAINTENANCE	5
3.3	DMX-512	7
4.	DISPLAY MENU	9
5.	DMX FUNCTIONS AND VALUES	11

## 1. INTRODUCTION

---

Thank you for choosing our product! Please consult this manual for any safety reasons, to ensure a painless and trouble-free operation, as well as for any reference needed.

We encourage you to check out our other products at our website: <http://slservice.pl/> !

## 2. SAFETY INFORMATION

---

To maintain this device's condition and to ensure a safe operation, it is absolutely necessary for the user to follow these safety instructions and warning notes written in this user manual.

- This device falls under protection-class I. Therefore it is essential that the device should be earthed.
- The electric connection and installation should be done by qualified personnel in order to minimize the risk of accidental electric shock and damaging the device.
- Always disconnect from the mains, when the device is not in use or before cleaning it. Only handle the power cord by the plug. Never pull out the plug by tugging the power cord.
- Make sure the power cord is never crimped or damaged by sharp edges - if this would be the case, immediately replace the cable for the exact same type.
- Before connecting the unit to the mains, make sure it is not damaged mechanically. If you notice any signs of damage, you should contact your dealer immediately. In this case do not connect the device to the mains.
- Make sure that the available voltage is not higher than 240V.
- Never look directly into the light source (especially if you have any epileptic past)!
- The device must be installed on a stable structure. Always use steel security cable to attach the device to a stable structure.
- Do not use this device in high humidity conditions and at temperatures above 40°C.
- Do not cover the ventilation slots when operating to avoid internal overheating.

- CAUTION: This product's housing may be hot when lights are operating.
- DO NOT connect this product to a dimmer or rheostat.

In case of a serious operating problem stop using this product immediately!

### **Important:**

Damages caused by a disregard of this user manual are not subject to warranty or any liability.

## **3. PRODUCT INFORMATION**

---

### **3.1 SPECIFICATION**

---

**Power supply voltage:** 100-240V

**Power consumption:** 300W

**Voltage frequency:** 50/60Hz

**Diode type and power:** 300W RGBLA 5in1 LED

**Number of diodes:** 1pcs

**Beam angle:** 25°-50°

**Scan rate:** 600/1200/2000/4000/6000/25000 Hz

**Dimming:** 16-bit dimmer

**DMX standard:** DMX 512

**DMX channels:** 6/8/8/11/17

**AC IN:** powerCON

**AC OUT:** powerCON

**DMX IN:** XLR - 3 pin

**DMX OUT:** XLR - 3 pin

**IP Rating:** IP20

**Cooling:** Active

**Height [cm]:** 37

**Width [cm]:** 37

**Depth [cm]:** 70

**Weight [kg]:** 10.3

## 3.2 CLEANING AND MAINTENANCE

We recommend a frequent cleaning of the device, as dust, smoke and other debris will build up on the optics and housing. After disconnecting the power wipe the device with a soft, lint-free and damp cloth. Never use alcohol or solvents, as these may damage the finish. A dry paint brush is an excellent tool to remove surface dust.

Be sure to periodically check for loose parts that could damage the device or potentially allow the device to cause injury. Make sure all overhead and wall installations have a secondary safety accessory installed, such as safety cable rated for your device type and size. Check the power cord as well, make sure there is no damage that could cause electrical shock, never remove the ground pin. There are no user-servicable parts in this device. Do not attempt to open and repair the fixture.



**CAUTION! Always disconnect from mains before starting any maintenance operation!**

There are no servicable parts inside the device. Maintenance and service operations are only to be carried out by authorized dealers. If you need any spare parts, please use only genuine parts. If the power supply cable of this device becomes damaged, it has to be replaced by authorized dealers only, in order to avoid hazards.

Never remove the ground pins from power cord nor spin any cooling fan with compressed air, as this can damage the components in your fixture.

If you have further questions, please contact your dealer.



**Before replacing a fuse, disconnect the power cord! Always replace with the same type and rating of fuse!**

## Mounting & rigging

This device can be mounted in any orientation (vertical, horizontal). Always make sure there is adequate ventilation and no flammable surfaces within 2 feet (0.6 meters) of the device. You can mount the device using clamps or with threaded bolt type hardware. Always install the included safety eyebolt and cable when mounting in overhead or wall locations.



**Warning: Do not mount the fixture in the ventilation path of a nearby heating supply duct. The heated airflow will cause device failure due to overheating.**

## Expected LED lifespan

LEDs gradually decline in brightness over time, mostly because of heat. Packaged in clusters, LEDs exhibit higher operating temperatures than in ideal, single LED conditions. For this reason, using clustered LEDs at their fullest intensity significantly reduces the LEDs' lifespan. Under normal conditions, this lifespan can be 40'000 to 50'000 hours.

If extending this lifespan is vital, lower the operating temperature by improving the ventilation around the product and reducing the ambient temperature to an optimal operating range. In addition, limiting the overall projection intensity may also help to extend the LEDs' lifespan.

### 3.3 DMX-512

To link devices together you'll need data cables. You should use data grade cables that can carry a high quality signal and are less prone to electromagnetic interference. For instance, Belden© 9841 meets the specifications for EIA RS-485 applications. Standard microphone cables will **probably** be OK, but note that they cannot transmit DMX data as reliably over long distances. In any event, the cable should have the following characteristics:

- 2-conductor twisted pair plus a shield,  
- maximum capacitance between conductors - **30pF/ft**,  
- maximum capacitance between conductor & shield - **55 pF/ft**,  
- maximum resistance of **20 ohms / 1000 ft** (304.8m in normal),  
- nominal impedance **100 - 140 ohms**.

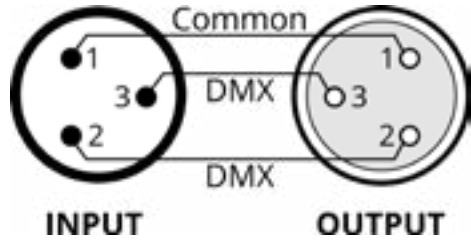

#### Cable connectors:

Cables must have a male XLR connector on one end and a female XLR connector on the other end (duh!).

A word on termination: DMX is a resilient communication protocol, however errors still occasionally occur. Termination reduces signal errors, and therefore best practises include the use of terminator in all circumstances. If you are experiencing problems with erratic device behavior, especially over long cable runs, a terminator may help improve performance.

#### To build your own DMX Terminator:

Obtain a 120-ohm, 1/4-watt resistor and wire it between pins 2 & 3 of the last fixture. They are also readily available from specialty retailers.

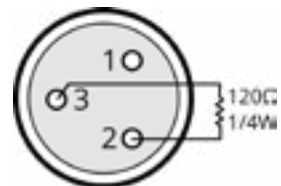

A DMX terminator

**CAUTION:** Do not allow contact between the common and the device's chassis ground. Grounding the common may cause a ground loop, and your device may perform erratically. Test cables with an ohm meter to verify correct polarity and to make sure the pins are not grounded or shorted to the shield or each other.

### 3-Pin / 5-Pin

If you use a controller with a 5 pin DMX output connector, you will need to use a 5 pin to 3 pin adapter. They are widely available over the Internet and from specialty retailers, but if you'd like to build your own, the table below details a proper cable conversion:

Conductor	3-Pin female (Output)	5-Pin male (Input)
Ground/Shield	Pin 1	Pin 1
DMX Data (-)	Pin 2	Pin 2
DMX Data (+)	Pin 3	Pin 3
Not used.	no connector	Pin 4
Not used.	no connector	Pin 5

### Setting up DMX control

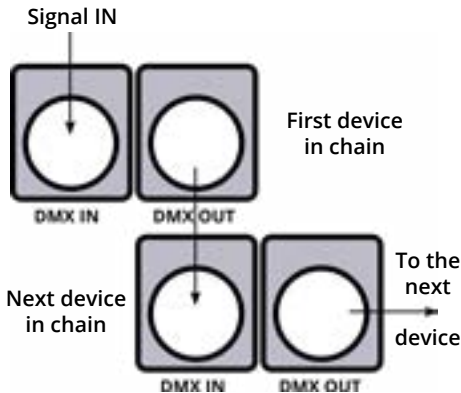

**Step 1:** Connect the male connector of the DMX cable to the female connector (output) on the controller.

**Step 2:** Connect the female connector of the DMX cable to the first device's male connector (input).

*Note:* It doesn't matter which device address is the first one connected. We recommend connecting the device in terms of their proximity to the controller, rather than connecting the lowest device number first, and so on.

**Step 3:** Connect other devices in the chain from output to input as above. Place a DMX terminator on the output of the final device to ensure the best communication.

### Fixture linking (Master/Slave Mode)

1. Connect the (male) 3-pin connector side of the DMX cable to the output (female) 3-pin connector of the first device.
2. Connect the end of the cable coming from the first device, which will have a (female) 3-pin connector to the input connector of the next device consisting of a (male) 3-pin connector. Then, proceed to connect from the output as stated above, to the input of the following device (and so on).



## 4. DISPLAY MENU

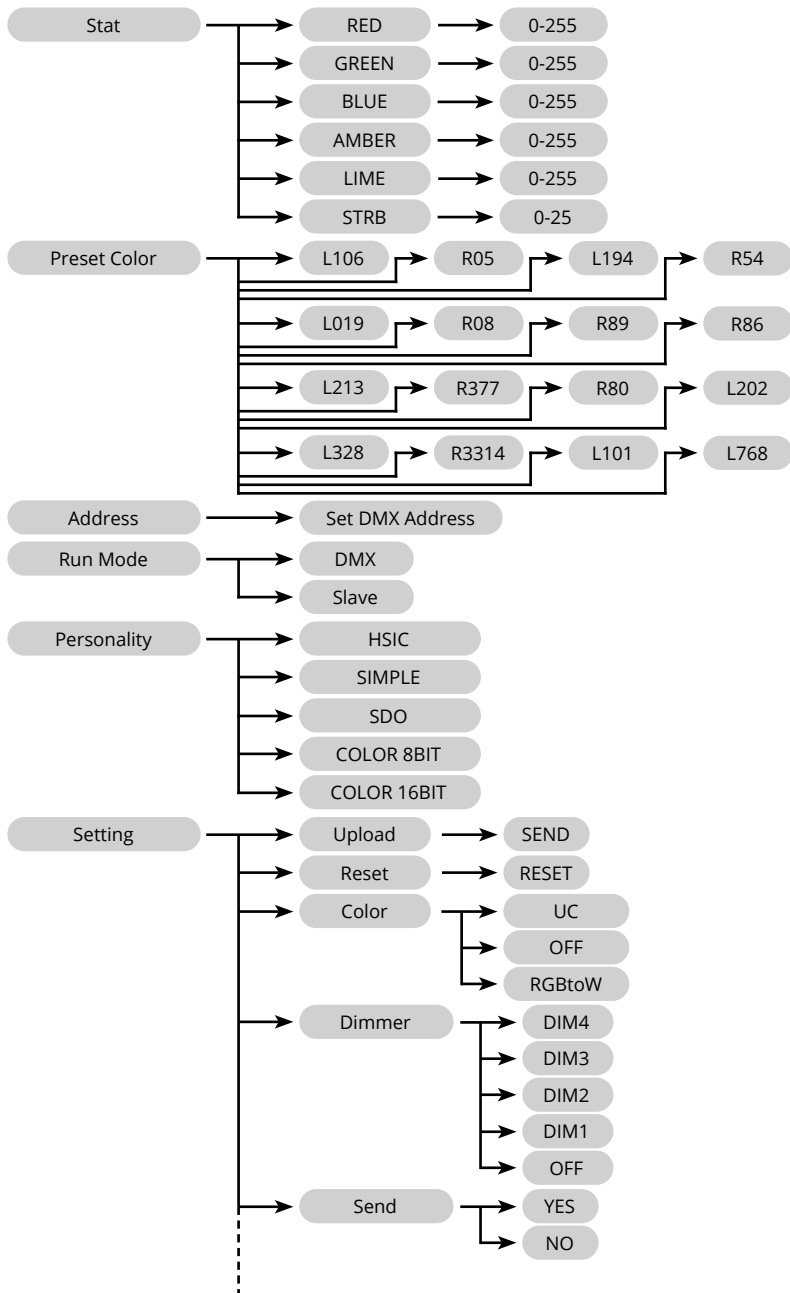

## 4. DISPLAY MENU CONT.

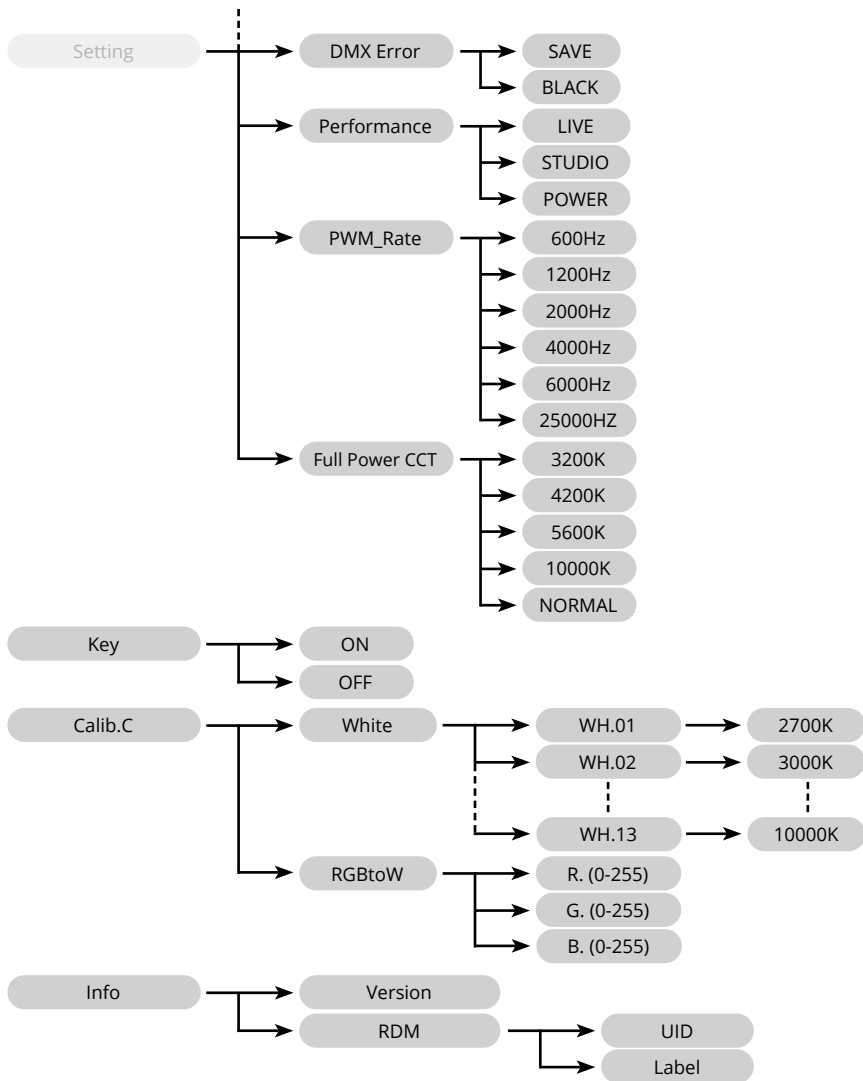

## 5. DMX FUNCTIONS AND VALUES

1	0-255	Intensity
2	0-255	Hue
3	0-255	Hue Fine
4	0-255	Saturation
5		CCT
	0-010	No Function
	11-030	2700K
	31-050	3000K
	51-070	3200K
	71-090	3500K
	91-110	4000K
	111-130	4200K
	131-150	4500K
	151-170	5600K
	171-190	6000K
	191-210	6500K
	211-230	7200K
	231-255	8000K
6		STROBE
	0-009	No Function
	10-099	Strobe (slow <--> fast, 0-25Hz)
	100-109	No Function
	110-179	Lightning Strobe
	180-189	No Function
	190-255	Random Strobe
7		DIMMER SPEED
	0-009	Preset Dimmer Speed (from display menu)
	10-029	OFF
	30-069	DIM1
	70-129	DIM2
	130-189	DIM3
	190-255	DIM4
8		DIMMER SPEED
	0-009	No Function
	10-080	LIVE
	81-160	STUDIO
	161-240	POWER
	241-255	No Function

HSIC

1	0-255	Master Dimmer
2	0-255	Red
3	0-255	Green
4	0-255	Blue
5	0-255	Lime
	0-255	Amber
		STROBE
	0-009	No Function
	10-099	Strobe (slow <--> fast, 0-25Hz)
	100-109	No Function
	110-179	Lightning Strobe
	180-189	No Function
	190-255	Random Strobe
		DIMMER SPEED
	0-009	No Function
	10-080	LIVE
	81-160	STUDIO
	161-240	POWER
	241-255	No Function

**SIMPLE**

1	0-255	Master Dimmer
2		PRESET COLOR
	0-010	No Function
	11-020	L106
	21-030	R05
	31-040	L194
	41-050	R54
	51-060	L019
	61-070	R08
	71-080	R89
	81-090	R86
	91-100	L213
	101-110	R377
	111-120	R80
	121-130	L202
	131-140	L328
	141-150	R3314
	151-160	L101
	161-170	L768
	171-255	No Function

**SDO**

3		CCT
	0-010	No Function
	11-030	2700K
	31-050	3000K
	51-070	3200K
	71-090	3500K
	91-110	4000K
	111-130	4200K
	131-150	4500K
	151-170	5600K
	171-190	6000K
	191-210	6500K
	211-230	7200K
231-255	8000K	
4		STROBE
	0-009	No Function
	10-099	Strobe (slow <--> fast, 0-25Hz)
	100-109	No Function
	110-179	Lightning Strobe
	180-189	No Function
190-255	Random Strobe	
5		DIMMER SPEED
	0-009	Preset Dimmer Speed (from display menu)
	10-029	OFF
	30-069	DIM1
	70-129	DIM2
	130-189	DIM3
190-255	DIM4	
6		DIMMER SPEED
	0-009	No Function
	10-080	LIVE
	81-160	STUDIO
	161-240	POWER
241-255	No Function	

SDO

1	0-255	Master Dimmer
2	0-255	Red
3	0-255	Green
4	0-255	Blue
5	0-255	Lime
6	0-255	Amber
7		PRESET COLOR
	0-010	No Function
	11-020	L106
	21-030	R05
	31-040	L194
	41-050	R54
	51-060	L019
	61-070	R08
	71-080	R89
	81-090	R86
	91-100	L213
	101-110	R377
	111-120	R80
	121-130	L202
	131-140	L328
	141-150	R3314
	151-160	L101
161-170	L768	
171-255	No Function	
8		CCT
	0-010	No Function
	11-030	2700K
	31-050	3000K
	51-070	3200K
	71-090	3500K
	91-110	4000K
	111-130	4200K
	131-150	4500K
	151-170	5600K
	171-190	6000K
	191-210	6500K
	211-230	7200K
	231-255	8000K

COLOR 8BIT

9		STROBE
	0-009	No Function
	10-099	Strobe (slow <--> fast, 0-25Hz)
	100-109	No Function
	110-179	Lightning Strobe
	180-189	No Function
	190-255	Random Strobe
10		DIMMER SPEED
	0-009	Preset Dimmer Speed (from display menu)
	10-029	OFF
	30-069	DIM1
	70-129	DIM2
	130-189	DIM3
	190-255	DIM4
11		DIMMER SPEED
	0-009	No Function
	10-080	LIVE
	81-160	STUDIO
	161-240	POWER
	241-255	No Function

**COLOR 8BIT**

1	0-255	Master Dimmer
2	0-255	Master Dimmer Fine
3	0-255	Red
4	0-255	Red Fine
5	0-255	Green
6	0-255	Green Fine
7	0-255	Blue
8	0-255	Blue Fine
9	0-255	Lime
10	0-255	Lime Fine
11	0-255	Amber
12	0-255	Amber Fine
13		PRESET COLOR
	0-010	No Function
	11-020	L106
	21-030	R05
	31-040	L194
	41-050	R54
	51-060	L019
	61-070	R08
	71-080	R89
	81-090	R86
	91-100	L213
	101-110	R377
	111-120	R80
	121-130	L202
	131-140	L328
	141-150	R3314
	151-160	L101
161-170	L768	
171-255	No Function	

**COLOR 16BIT**



14		CCT
	0-010	No Function
	11-030	2700K
	31-050	3000K
	51-070	3200K
	71-090	3500K
	91-110	4000K
	111-130	4200K
	131-150	4500K
	151-170	5600K
	171-190	6000K
	191-210	6500K
	211-230	7200K
	231-255	8000K
15		STROBE
	0-009	No Function
	10-099	Strobe (slow <--> fast, 0-25Hz)
	100-109	No Function
	110-179	Lightning Strobe
	180-189	No Function
190-255	Random Strobe	
16		DIMMER SPEED
	0-009	Preset Dimmer Speed (from display menu)
	10-029	OFF
	30-069	DIM1
	70-129	DIM2
	130-189	DIM3
	190-255	DIM4
17		DIMMER SPEED
	0-009	No Function
	10-080	LIVE
	81-160	STUDIO
	160-240	POWER
	241-255	No Function

**COLOR 16BIT**